

Proj. No.: 5908-002 State: GA County: HENRY Station: HC07-06

Year Established: 2007 Agency/Client: HENRY COUNTY

Type of Survey: GPS Accuracy Classification: THIRD Order, Class I

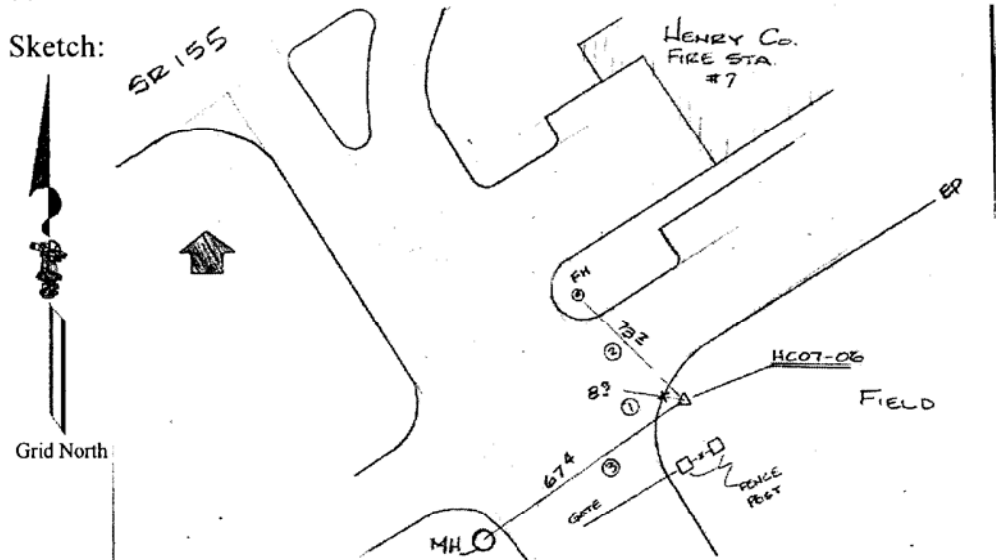

 Description STATION IS SE OF THE HENRY CO. FIRE DEPT. NO. 7 AND NE OF THE PARK
ENTRANCE. REFERENCE MARK 1, 8.9 FEET FROM EDGE OF PAVEMENT. REFERENCE MARK 2,
73.2 FEET FROM A FIRE HYDRANT. REFERENCE MARK 3, 67.4 FEET FROM THE CENTER OF
MANHOLE COVER. STATION IS A 2 IN. ALUM. DISK STAMPED "HC07-06".

GEODETIC POSITION

Latitude: 33° 29' 59.141864" N Longitude: 84° 08' 38.047091" W
 WGS84 () CLARK1866 ()
 GRS80 (X)
 Orthometric Height: 251.838 M. 826.239 Ft. Geoid Hgt.: -28.999 M.
 1988 NAVD (X) Geoid
 1929 NGVD () Model 03

STATE PLANE POSITION

State: GA Zone: WEST Zone #: 1002 Projection: TM
 NAD83 (X) Adj. (CORS96) 1927NAD ()

N: 1273042.371 US Ft.(X) E: 2303522.781 US Ft.(X)
 Int Ft. () Int Ft. ()
 N: 388024.091 M. E: 702115.148 M.

Combined Scale Factor: 0.99986508 Convergence: 0 00 45.233